

# The F & G Cantilever Bases

(model F & G are both shown)

2 year warranty

The “F” series cantilever style base utilizes 2” square heavy wall 14 gauge construction with angle support. Black painted finish.

## Sizes Available

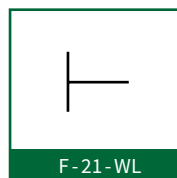

**F - 21 - WL**  
Top Capacity: 24" - 30"  
(16 lbs)

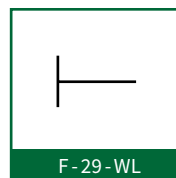

**F - 29 - WL**  
Top Capacity: 36" - 48"  
(18 lbs)

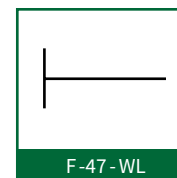

**F - 47 - WL**  
Top Capacity: 54" - 60"  
(25 lbs)

\*We recommend wall blocking at 12" and 27" to secure the cantilever.

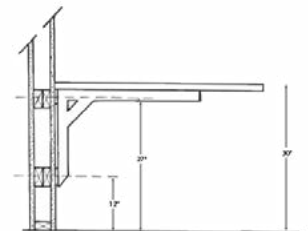

**F - 29 - WL**

The “G” series cantilever, utilizes 2” square heavy wall construction and includes table mounting bracket. Black painted finish.

## Sizes Available

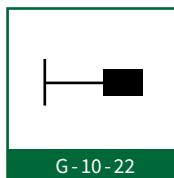

**G - 10 - 22**  
Top Capacity: 24" - 30"  
(10 lbs)

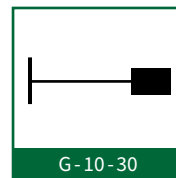

**G - 10 - 30**  
Top Capacity: 36" - 54"  
(12 lbs)

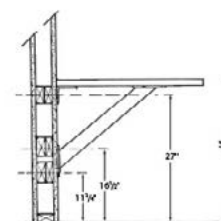

**G - 10 - 22**

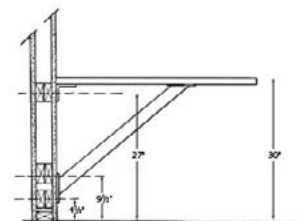

**G - 10 - 30**

**Questions:** If you have any questions, feel free to visit our website for more info or contact our office.